

GIANLUCA **SAIBENE** + VALERIO **SALA**

**COMUNE DI COLLE BRIANZA**

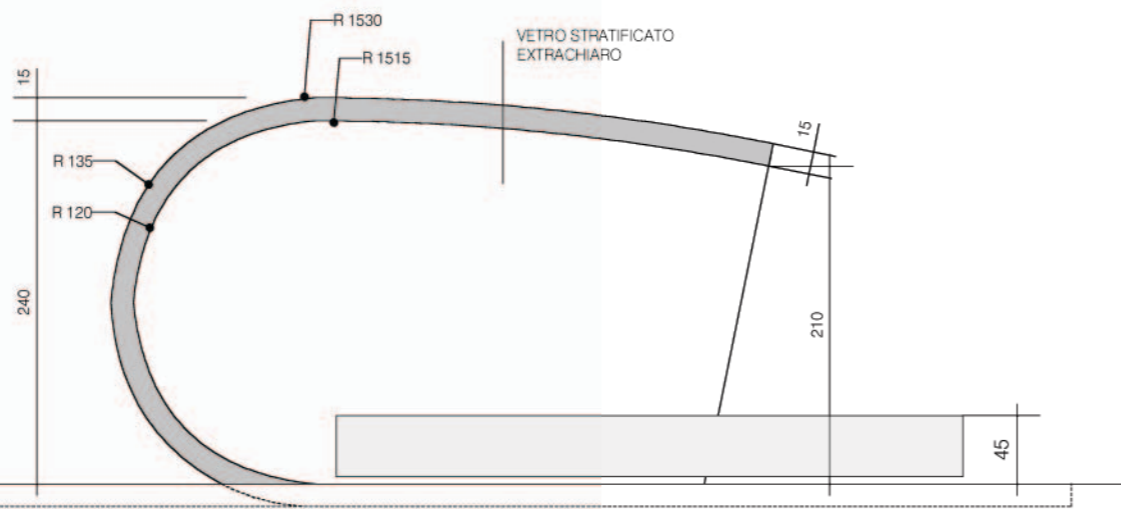

STUDIO DI FATTIBILITÀ E RIQUALIFICAZIONE  
DELLE **FERMATE DELLO SCUOLABUS** E  
DELLE AREE CIRCOSTANTI ALLE FERMATE



PROSPETTO A

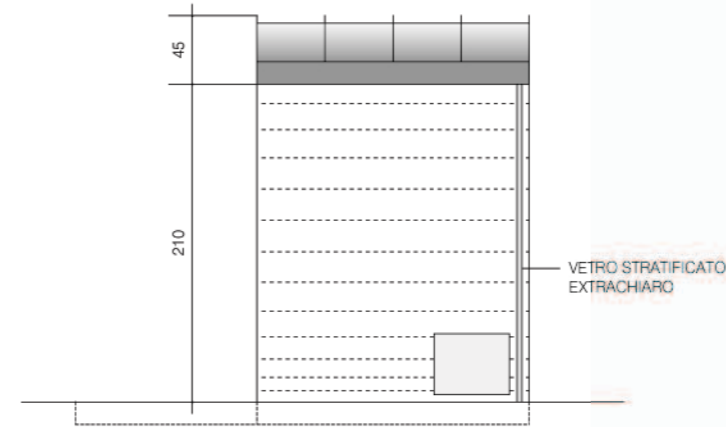

PROSPETTO B

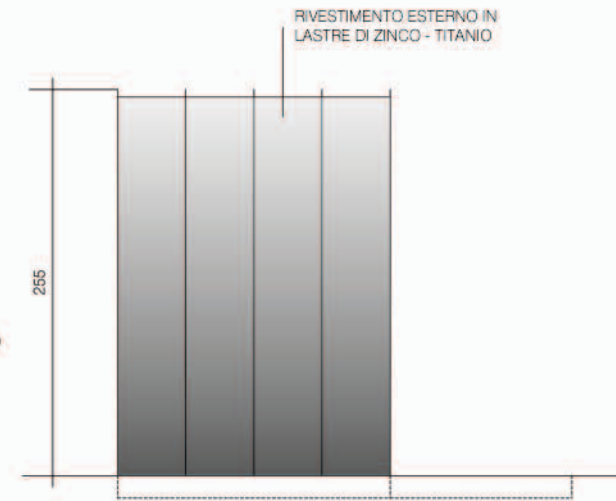

PROSPETTO C

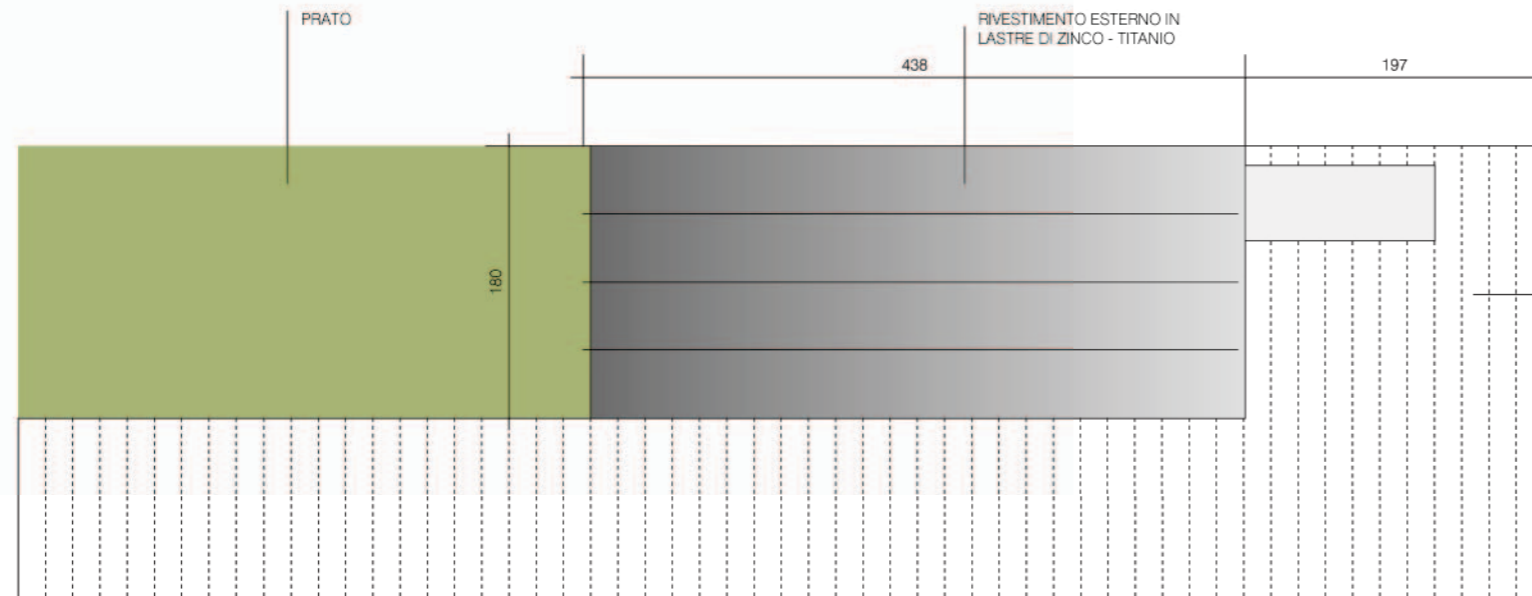

PIANTA COPERTURA

PAVIMENTO IN DOGHE DI LEGNO

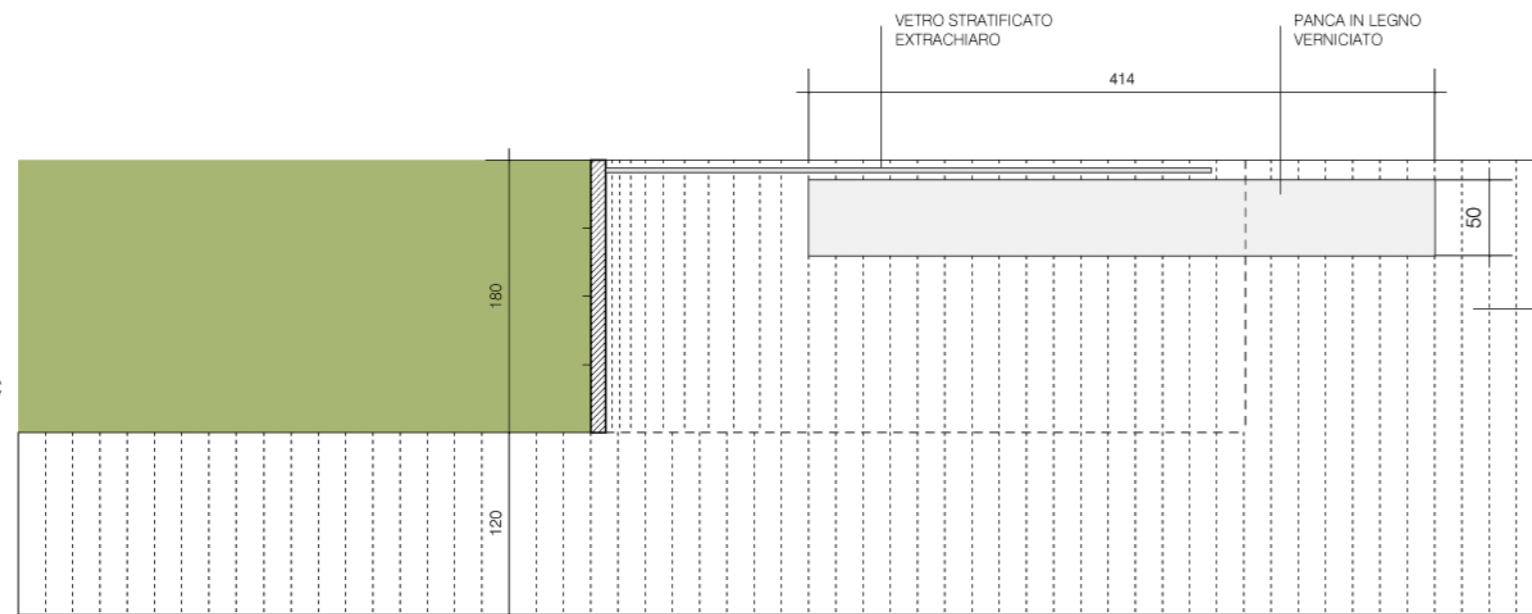
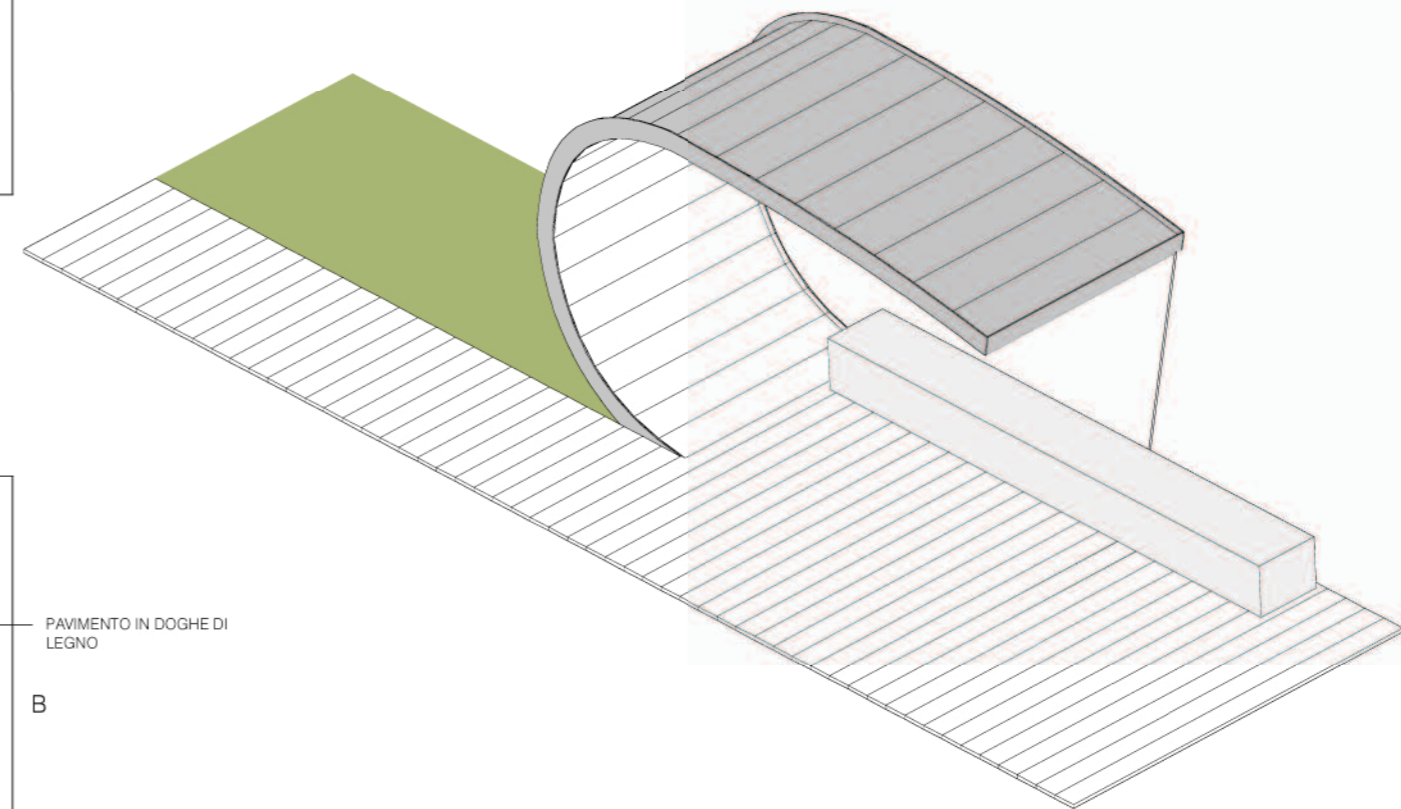

PIANTA

A

PAVIMENTO IN DOGHE DI LEGNO

B

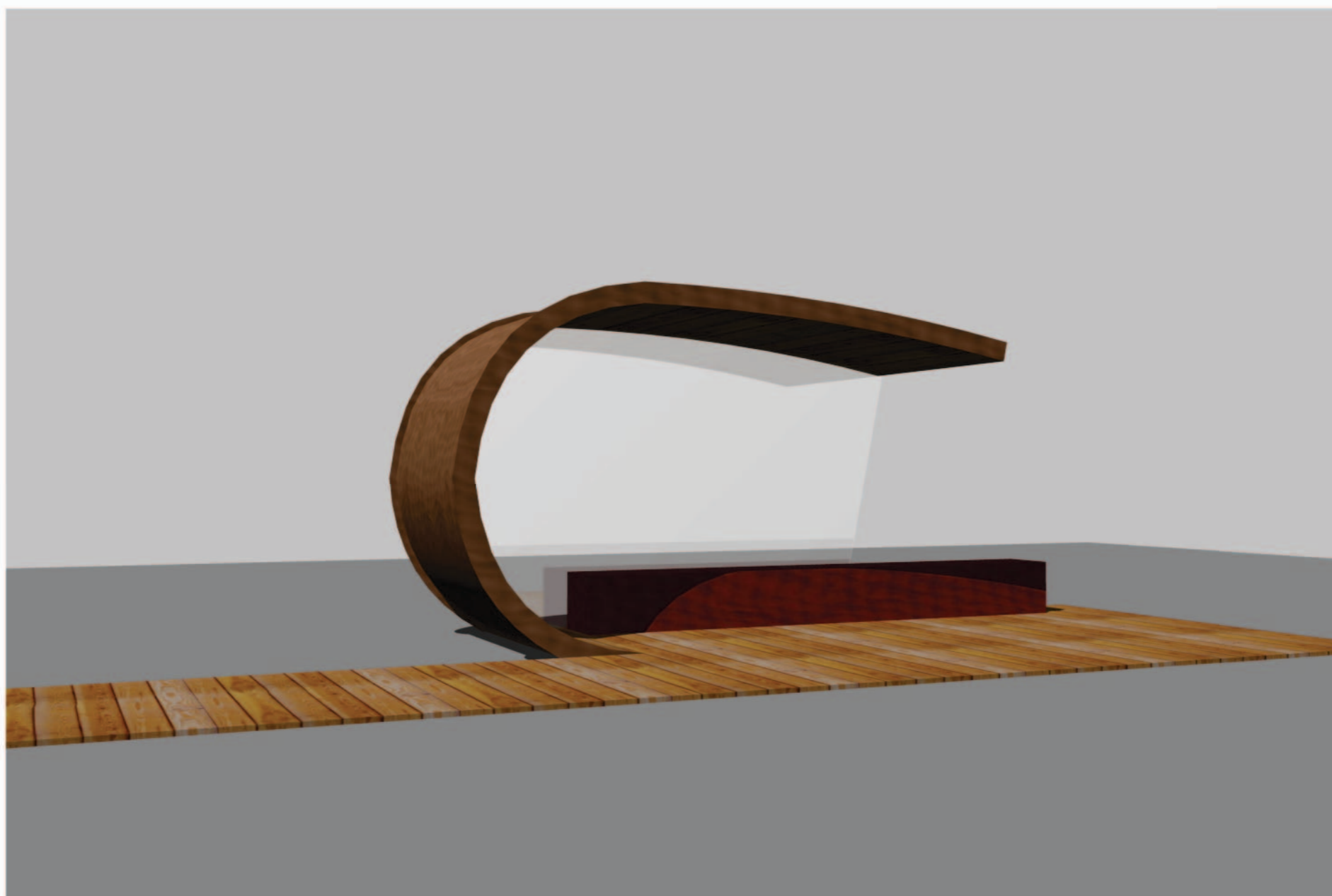

**FERMATA TIPO A** VISTA PROSPETTICA (SOLUZIONE CON RIVESTIMENTO IN RAME)

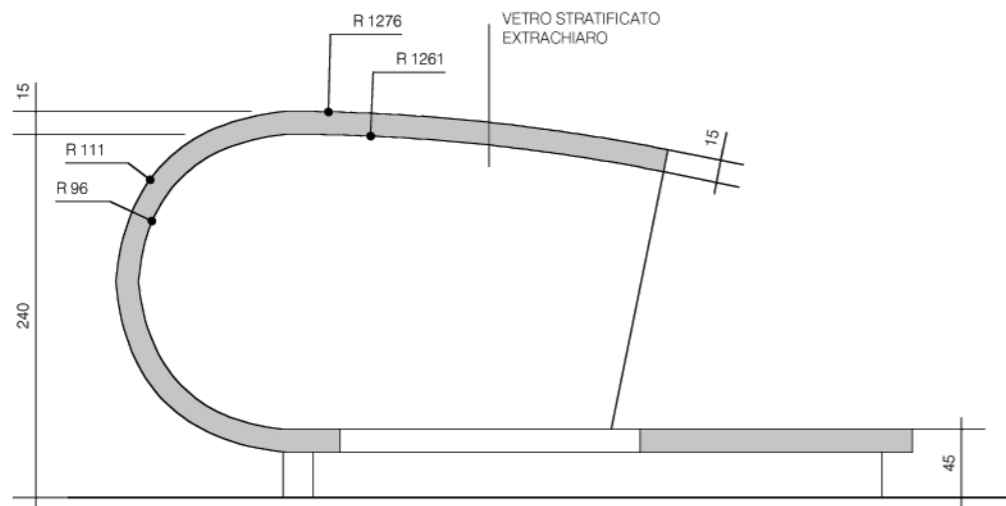

PROSPETTO A

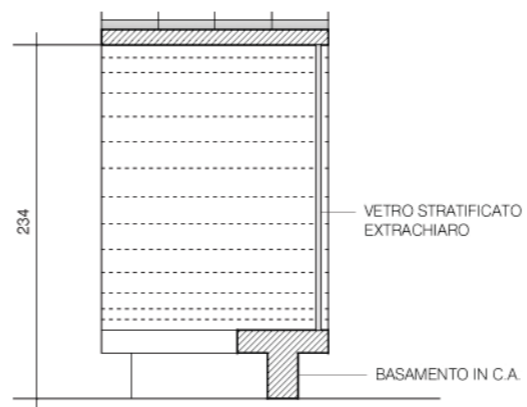

SEZIONE

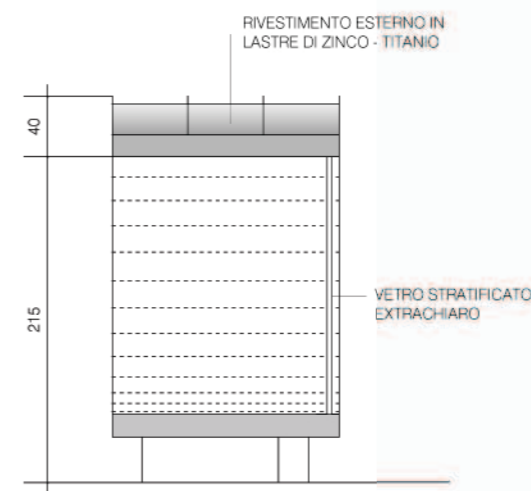

PROSPETTO B

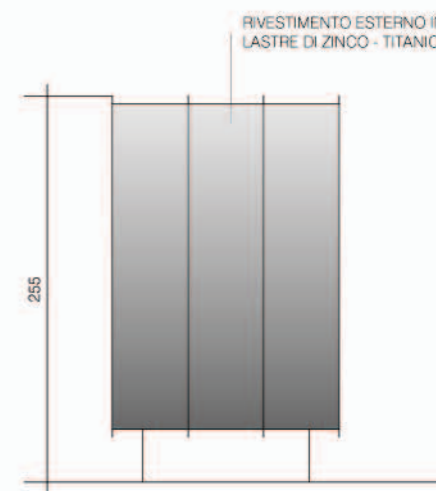

PROSPETTO C

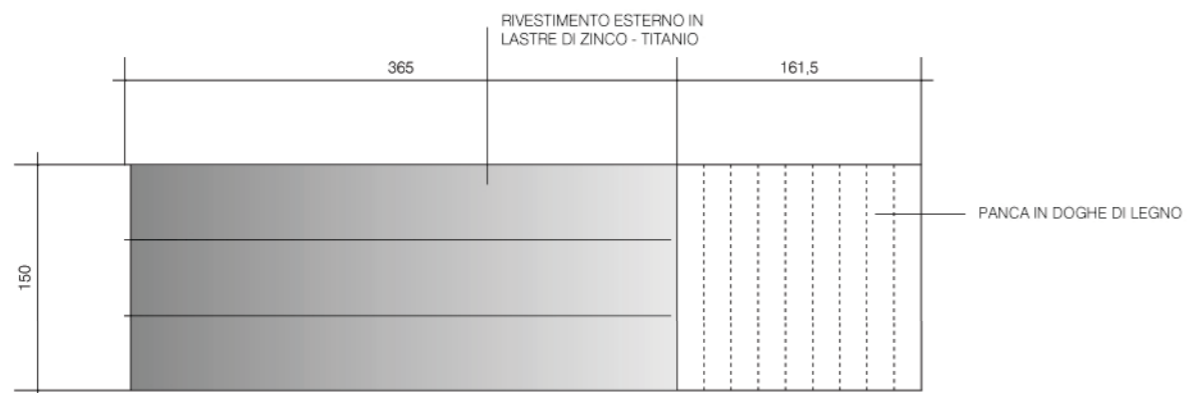

PIANTA COPERTURA

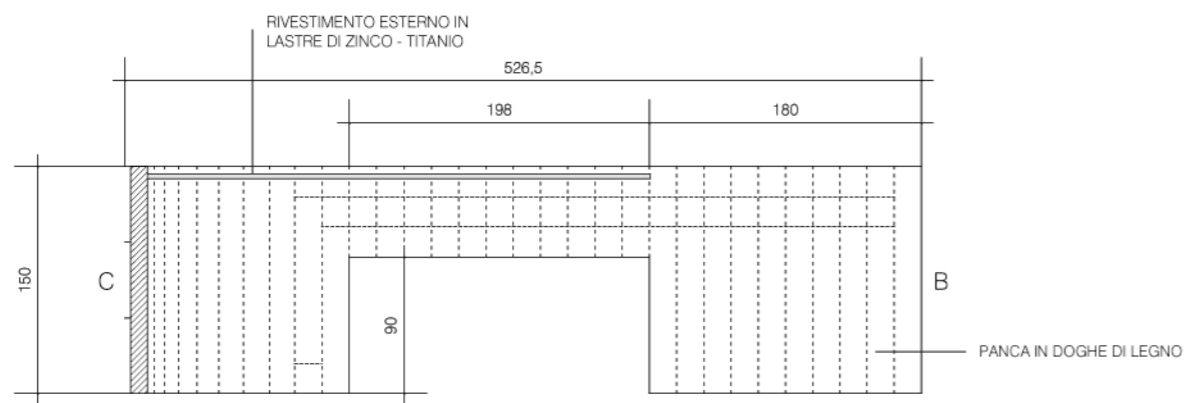

PIANTA

A

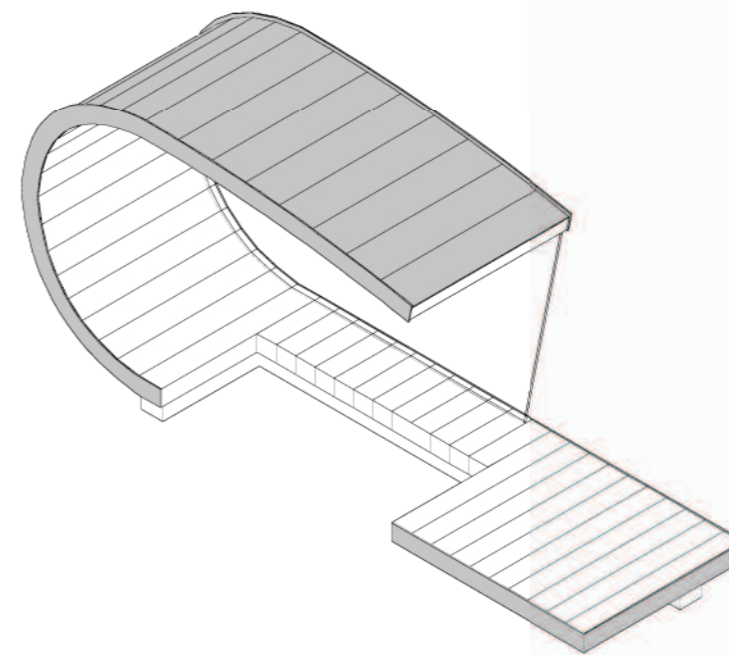

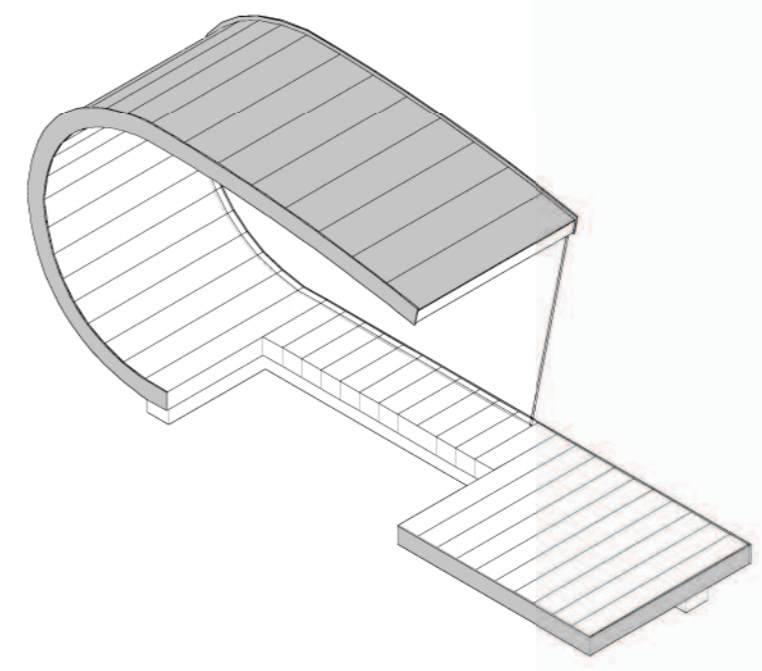
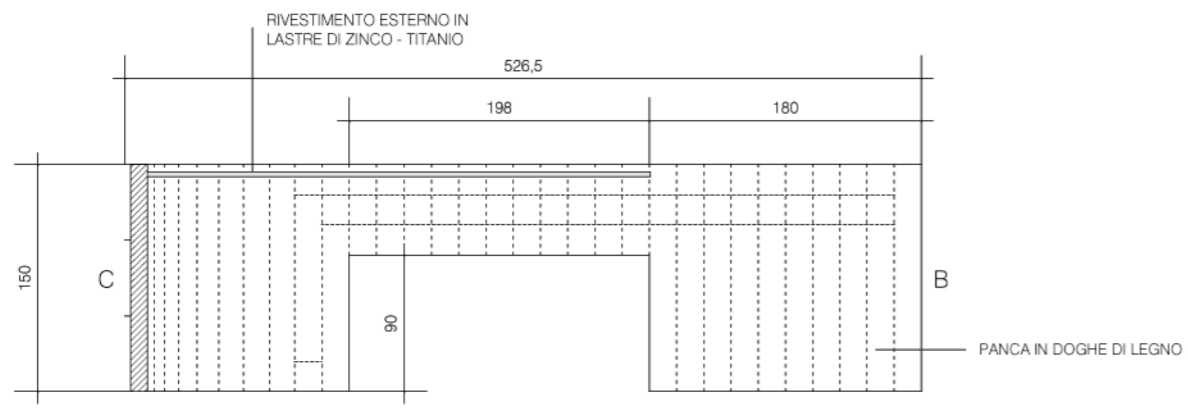
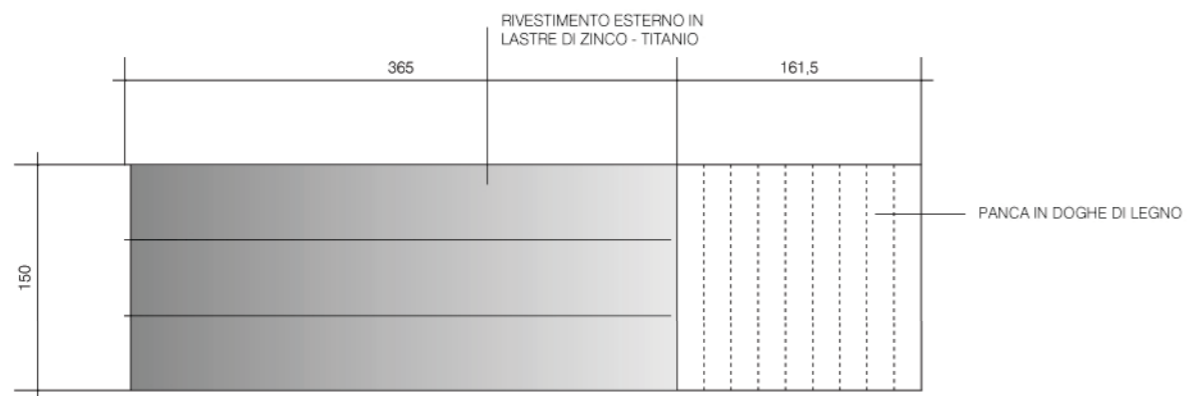
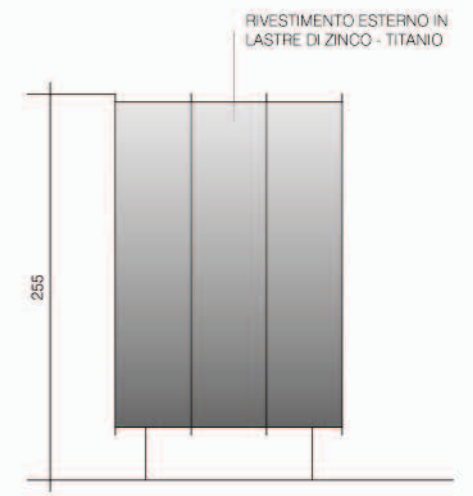
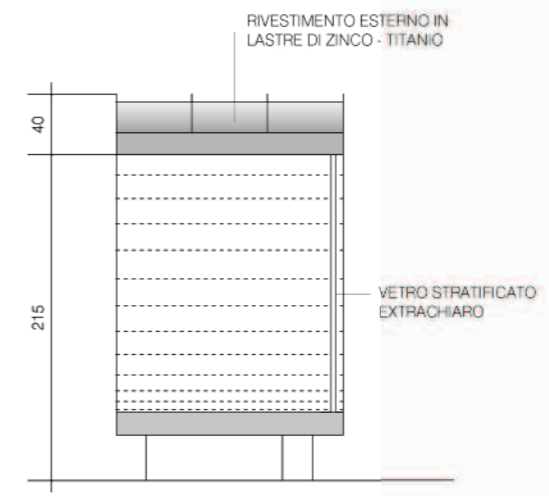
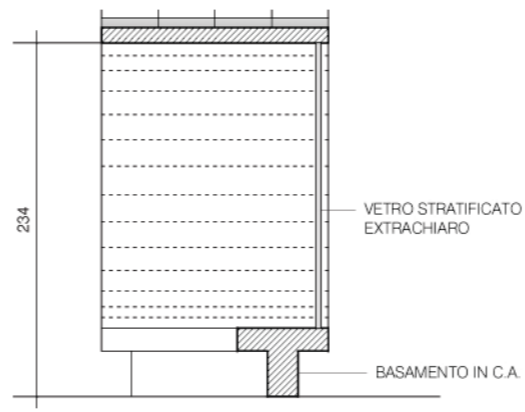
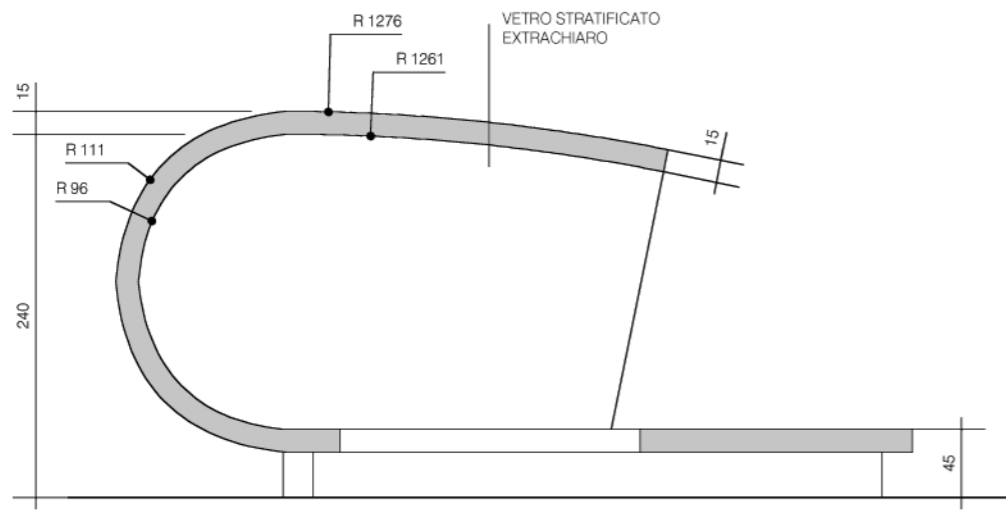

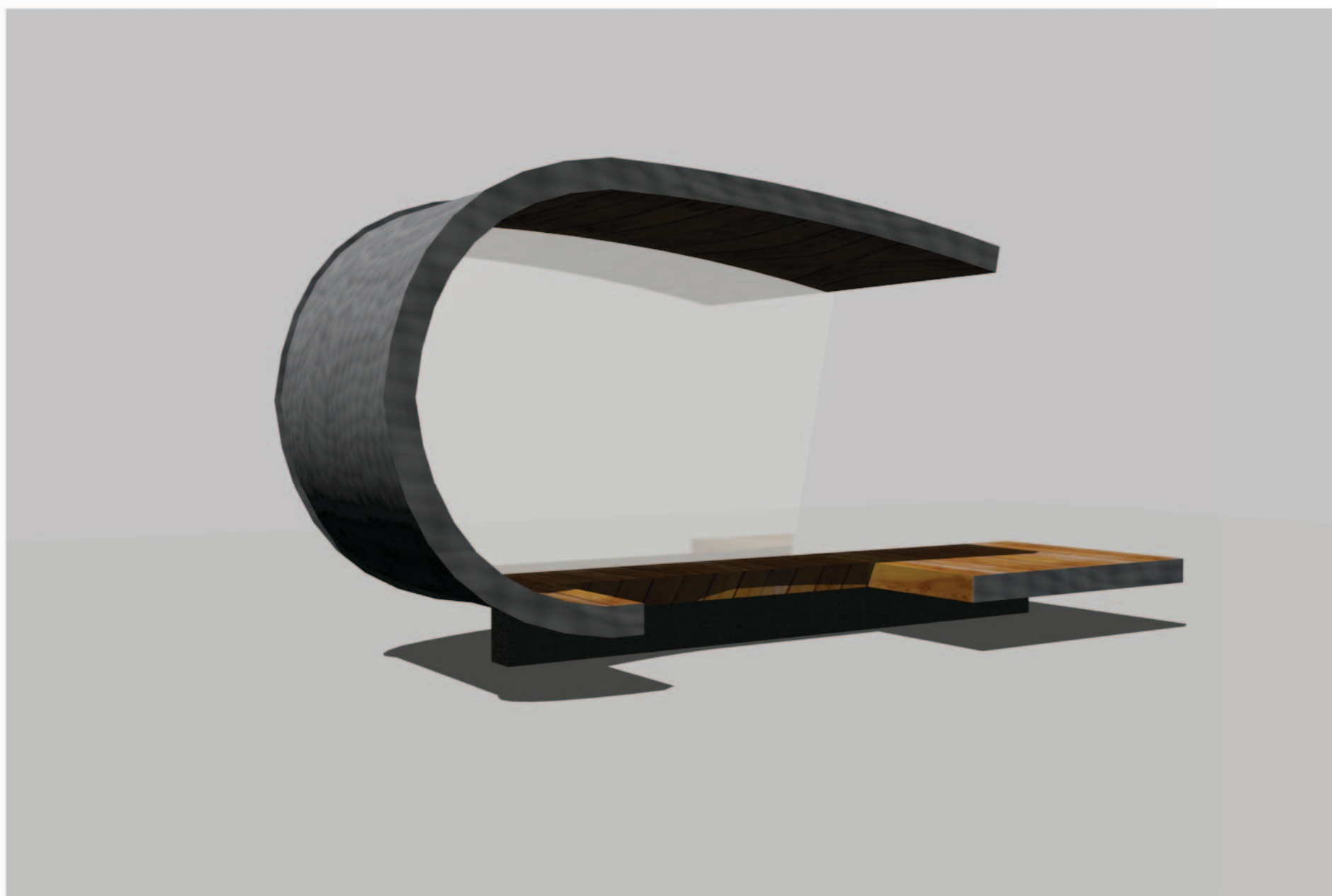

**FERMATATA TIPO B** VISTA PROSPETTICA